

**REQUEST FOR REVISION TO THE ZONING MAP  
ONE FORM PER TRACT/LOT OF LAND  
PLEASE REVIEW INSTRUCTIONS PRIOR TO SUBMITTING AN APPLICATION**

PLEASE PRINT ALL

1. Lester Sinclair Name - Property Owner      Mary Williams Potential Buyer/Lessee  
93997 Daisy Dr. Address      7601 W Hwy 124 Address  
Corona, CA 92883 City State/Zip      65256 City State/Zip  
951-858-9702 Phone      573-682-0085 Phone  
~~\* harmonyanselhypnosis@gmail.com~~ Owner Email Address      ~~Maria Williams 879~~ Buyer Email Address      merikwilliams574722@yahoo.com

2. Legal description of land for which revision to zoning map application is made. Please attach copy of Warranty Deed, Deed of Trust, or survey.

Section 13 Township 5D Range 14 Parcel #: 05 - 600 - 13 - 00 - 005.00 01  
05 - 600 - 13 - 00 - 005-0101

3. Present zoning and actual land use: recreational

4. Lot/tract size: 7.07 Acres/Sq. Ft.      5. Requested zoning district: A-2      6. Adjacent zoning A-2/PEC

7. Proposed use should the request to rezone be approved: (Please be as detailed as possible in describing the proposed use)  
~~rental property~~ Residential single family home on property

8. Reason and justification for the request being submitted: property is zoned recreational, needs rezoned for residential

9. Approximate size, use and location of any structure(s): Include sketch.  
 Existing: 14' x 80' Proposed: \_\_\_\_\_

10. Type of wastewater system: Lagoon

11. Date of Concept Review (If no concept review was held, state "None"): \_\_\_\_\_

**12. REQUIRED WITH INITIAL SUBMITTAL: (ADDITIONAL DOCUMENTATION MAY BE REQUIRED AT A LATER DATE)**

- Application FEE of \$385.00 (or current fee)
- Review Plan FEE (if applicable) of \$300.00 (or current fee)
- Final Plan FEE (if applicable) of \$100.00 (or current fee)
- Copy of recorded Warranty Deed, Deed of Trust, or survey showing proof of ownership
- List of property owners within 1000 feet of property (you may obtain from Assessor's Office)
- If requesting Planned Zoning, all documentation required in Zoning Regulations Section 6.4
- Additional Fees will be billed later including: Certified Mailings of \$8.10 per notice (or current cost) and Newspaper fees which must be paid by Friday the week prior to the scheduled meeting unless otherwise noted. Indicate below who will pay additional fees. Failure to pay these additional fees by the due date may result in the item being removed from the agenda.
- Additional fees to be paid by Representative
- Additional fees to be paid by Owner
- Additional fees to be paid by Potential Buyer/Lessee

13. The above information is true and correct to the best of my knowledge.

\* Lester M. Sinclair Owner's Signature (REQUIRED)      10-27-24 Date      Mary Williams Potential Buyer's/Lessee's Signature      9-20-24 Date

14. Representative: (Surveyor, Engineer, Attorney, Etc.)

Name \_\_\_\_\_ Business/Company Name \_\_\_\_\_  
 Address \_\_\_\_\_ Office Phone Number \_\_\_\_\_  
 City, State, Zip \_\_\_\_\_ Email Address merikwilliams574722@yahoo.com

NOTE: Please attach any additional documentation, sketches, permits, names, and addresses as required as minimum information. Failure to provide any of the required material will result in the invalidation of the application. If you plan to show a power point or other digital presentation during the meeting(s) please provide staff a copy at least 24 hours in advance of the meeting date.

Received by: [Signature] Date 1/3/2025 Time: \_\_\_\_\_  
 Boone County Planning and Building Inspections

2781



# Parcel Properties within 1,000 ft

Selection for Parcel 05-600-13-00-005.00 01 and 05-600-13-00-005.01 01



- Roads
- Selected Parcels
- Parcels within 1,000ft
- Parcel Boundaries

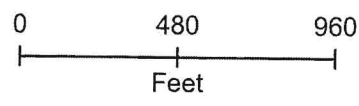

Date: 1/29/2025

Parcel Data Source  
Boone County Assessor

Created By:  
Boone County  
Resource Management



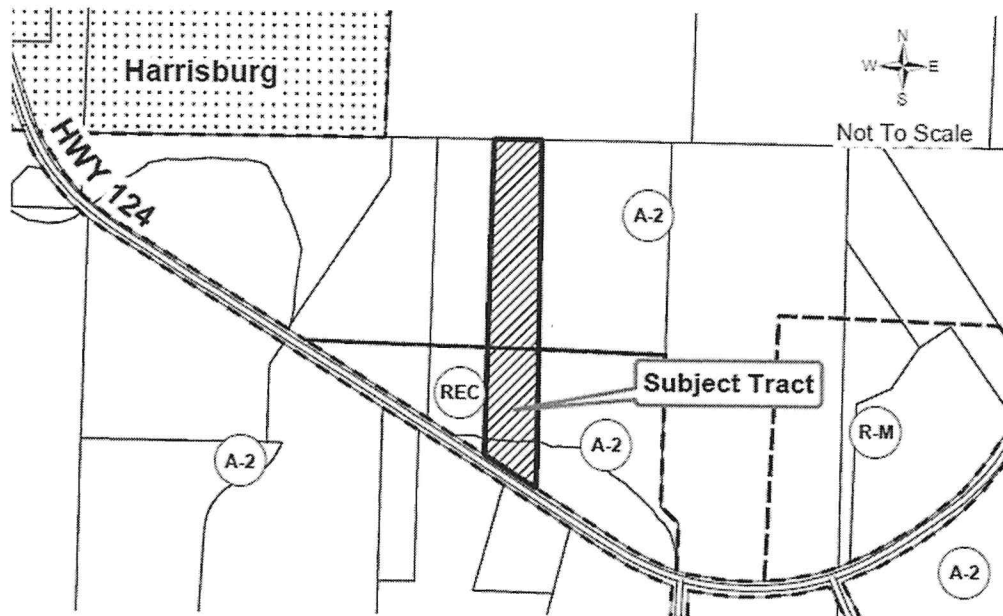

## NOTICE OF PUBLIC HEARING BOONE COUNTY, MISSOURI

Notice is hereby given of a public hearing to be held before the Boone County Planning and Zoning Commission at 7:00 P.M. on Thursday, February 20, 2025 in Commission Chambers, Roger B. Wilson Boone County Government Center, 801 E. Walnut St., Columbia, MO, and before the Boone County Commission at 7:00 P.M. on Tuesday, March 11, 2025, in Commission Chambers at the Roger B. Wilson Boone County Government Center, 801 E. Walnut St., Columbia, MO. The hearings will give all interested parties an opportunity to be heard in relation to the following:

**Request by Mary Williams on behalf of Sinclair & Heather Lester to rezone from Agriculture 2 (A-2) and Recreation (REC) to A-2 on 7.07 acres located at 7601 W Hwy 124, Harrisburg.**

Questions regarding the above request may be directed to the Boone County Resource Management office at (573) 886-4330.

Boone County Planning & Zoning Commission  
Boyd Harris, Chairperson